

Handwritten notes and signatures in the top right corner.

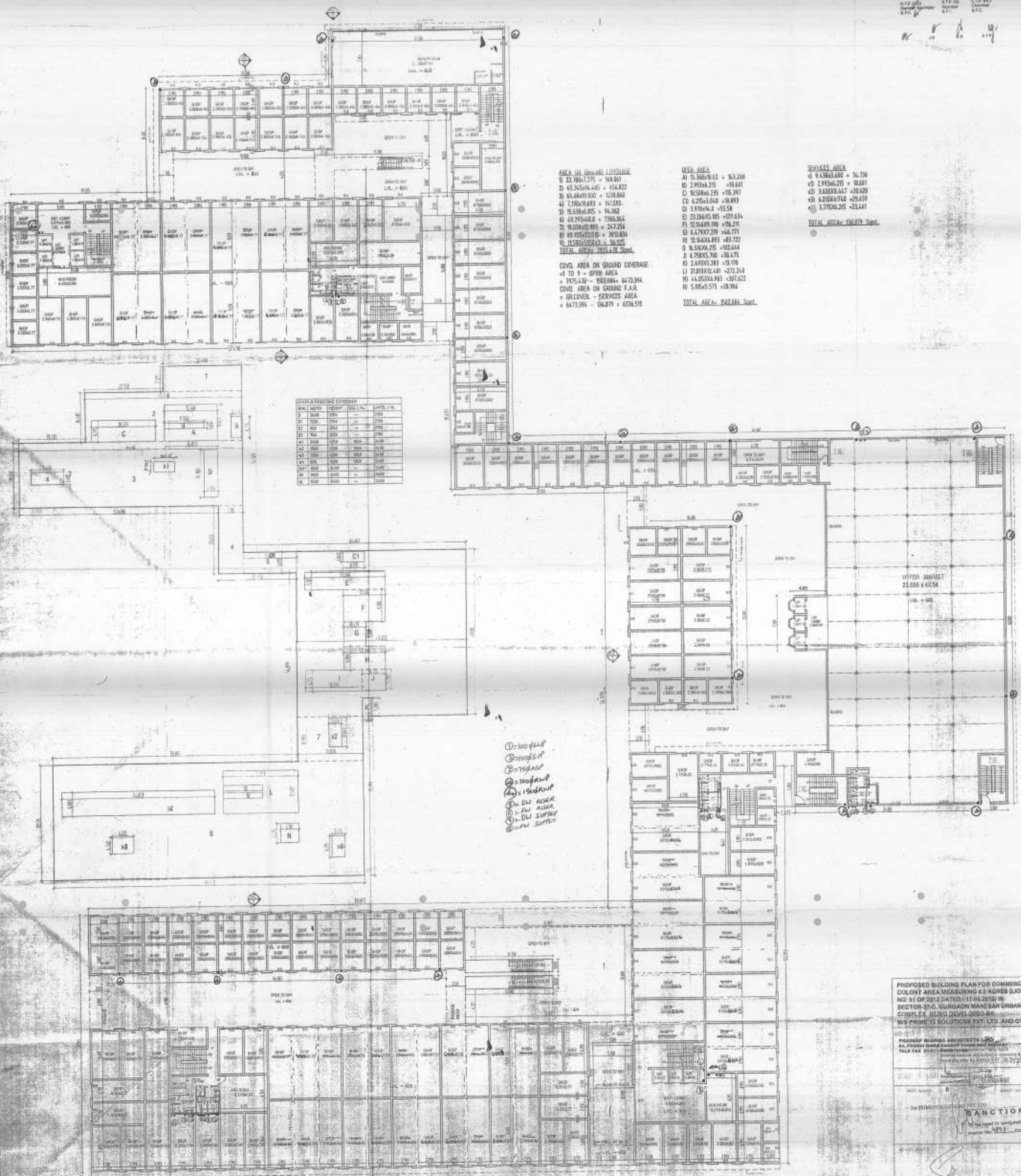

AREA OF PROPOSED BUILDING

1	22,806.375	= 14,861
2	42,524.425	= 15,827
3	41,449.830	= 13,889
4	1,700.949	= 11,592
5	51,526.825	= 16,460
6	41,275.848	= 20,964
7	10,038.129	= 24,228
8	40,955.525	= 30,884
9	11,520.024	= 36,320

TOTAL AREA: 275,114 Sqm.

CIVIL AREA ON GROUND COVERAGE

1 TO 9	275,114	= 275,114
CIVIL AREA ON GROUND F.A.R.	647,394	= 647,394
GROUND - SERVICE AREA	647,394	= 647,394

AREA OF PROPOSED BUILDING

A	5,326.812	= 63,208
B	2,924.225	= 18,441
C	10,584.225	= 18,397
D	4,252.645	= 18,881
E	3,924.4	= 5,528
F	23,245.105	= 102,434
G	21,849.705	= 18,225
H	4,170.219	= 44,771
I	10,524.619	= 43,727
J	18,524.225	= 102,644
K	6,785.700	= 28,475
L	2,495.211	= 9,171
M	7,817.141	= 22,214
N	11,053.493	= 37,122
O	5,855.571	= 18,944

TOTAL AREA: 542,181 Sqm.

SERVICE AREA

1	4,824.849	= 31,750
2	2,193.225	= 10,011
3	3,483.447	= 18,429
4	4,252.645	= 22,459
5	1,752.225	= 23,441

TOTAL AREA: 156,179 Sqm.

SCOPE AND WORKS COVERED

NO.	DESCRIPTION	DATE	STATUS
1
2
3
4
5
6
7
8
9
10
11
12
13
14
15
16
17
18
19
20

Handwritten notes: 100 feet, 100 feet, 100 feet, 100 feet, 100 feet, 100 feet, 100 feet, 100 feet, 100 feet, 100 feet.

PROPOSED BUILDING PLAN FOR COMMERCIAL COLONY AREA, MEASUREMENTS AS AGREEE EVIDENCE NO. 81 OF 2015 DATED: 11.06.2015 IN SECTOR 27-C, GUARDIAN MANEER URBAN COMPLEX, BANGALORE DISTRICT, KARNATAKA.

BY: M/S PRIME IT SOLUTIONS PVT. LTD. AND OTHERS.

APPROVED BY: ...

DATE: ...

SANCTIONED

BY: ...

DATE: ...

FOR: ...

GROUND FLOOR PLAN